

# UNIVERSITY OF WISCONSIN- SUPERIOR



# ON-CAMPUS HOUSING GUIDE

# WELCOME

Dear UW-Superior student,

It is with great excitement that we welcome you to, or welcome you back to, the residence halls at the University of Wisconsin-Superior, “Your Home Away From Home.”

The staff of the Residence Life Department is dedicated to making your experience at UWS an enjoyable and successful one. We hope to support you in the areas of academics, interpersonal development, personal growth, and social interaction. We strive to make the community you live in open, inviting, and fun. We hope to involve you in floor, building, and campus activities to help you meet new people and to ensure you have a strong connection to the University and campus community.

We hope to be a resource for you, to direct you to the on campus services you need, and to invite you to participate in campus organizations. Welcome to UW-Superior and the opportunities that await you here.

Sincerely,



Ryan Kreuser  
Director of Residence Life

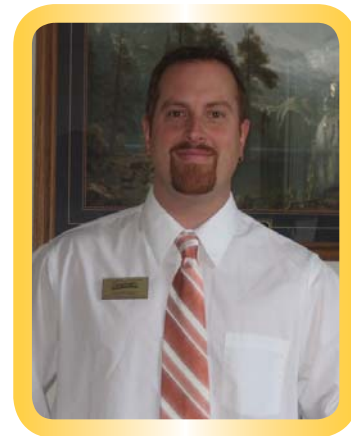

## RESIDENCE LIFE MISSION STATEMENT

The mission of the Residence Life program, in order to support the academic endeavors of the residence halls students, is to provide a safe, structurally sound, and accepting living and learning environment through educational programming and personal contact.



# THE 4 C'S OF ON-CAMPUS LIVING...

## COMMUNITY

“The halls are a great place to live. It’s nice keeping the door open and socializing with the rest of the residents. It’s great for making friends and making what is almost like your family away from home.” “

Hometown: Phillips, WI  
Semesters: On-campus: 8; Off-campus: 0



-Cory Mareno

## COMMUTE

“By living on campus, I don’t have to drive every day and hope to find a parking spot. I can walk to my classes, the cafeteria, and the wellness center in ten minutes or less.”

Hometown: Clear Lake, WI  
Semesters: On-campus: 8; Off-campus: 0

-Kathryn DeBoer

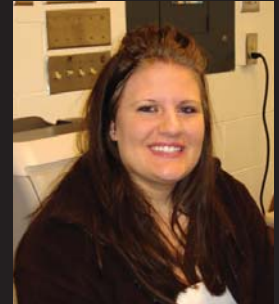

## COMPARABLE

“When you break down the cost of living on campus vs. off campus, it is fairly comparable. When you live off campus you have to pay separate bills for utilities, cable t.v., internet, food, etc. When you live on campus all amenities are included in the cost. “

Hometown: Weyauwega, WI  
Semesters: On-campus: 6; Off-campus: 3



- Brian Juve

## CONVENIENCE

“I appreciate the fact that I can walk outside the residence hall and easily visit with my advisor or study at the library.”

Hometown: Two Harbors, MN  
Semesters: On-campus: 4; Off-campus: 0

- Lynn Wistrom



# RESIDENCE LIFE

## CREATING A POSITIVE LIVING COMMUNITY

Each person brings uniqueness to our community. However, just as families share responsibilities and show consideration, so do members of a residence hall community. You must respect other residents of your hall, be considerate of their study and sleep needs, and do your part to keep the hall clean and safe. The more you contribute to your hall community and become involved, the more you will get out of your residence hall experience.

## RESIDENCE LIFE STAFF

Our staff continually strives to keep the environment in your hall safe, clean, and accepting; one that promotes academics while at the same time developing social activities.

The staff also provides advice, refers students to University resources, and mediates conflicts. Staff members are here to assist you any way they can.

Your **HALL MANAGER** supervises the entire operation of your hall. This includes programming, maintenance, and discipline. He or she can usually be found in his or her office during the business day. Each hall also has an **ASSISTANT HALL MANAGER**. His or her primary job is to help the director oversee the management of the hall operations.

The person you will most likely have contact with on a day-to-day basis is your **RESIDENT ASSISTANT**. Your RA is a fellow student whose primary job is to develop a positive and cooperative floor community through resident interaction and programming. RAs assist residents in problem resolution, enforce university and housing policies, implement floor programs, and provide referrals to a variety of campus resources.

Another person you will have contact with is your hall **ACADEMIC RESOURCE COORDINATOR**. This person is a student whose primary job is to assist you with your academic concerns. Your ARC plans and implements creative programs which will allow you to enhance your time management, study, and other skills that will make your experience at UW-Superior a positive one. ARCs also provide the ASAP program (ARCs Supporting Academic Progress). This is an individualized study skills program.

We also have **FRONT DESK STAFF** that provide service for you primarily in the late afternoon and evenings. If you need to buy a quick snack, check out a Nintendo Wii, vacuum, cooking utensils, or pool cues and balls - they are the people to see.

Our **CUSTODIAL STAFF** cleans the public areas of the halls. They work hard to make your home comfortable. With your cooperation and help, your hall will be a pleasant place to live.

The **MAINTENANCE STAFF** makes sure things are working properly in the halls. Fill out a work order via our website [atuwsuper.edu/reslife/forms/](http://atuwsuper.edu/reslife/forms/) or contact your Resident Assistant to complete a work order if something needs fixing in your room.

## ASAP PROGRAM

The ASAP (**ARCs Supporting Academic Progress**) program is coordinated by students serving as Academic Resource Coordinators (ARCs). The ASAP program is designed to give students living in the residence halls academic and life skills to help them succeed during their years at UWS and beyond. Being involved in the ASAP program allows students to have one-on-one sessions every other week with an ARC to cover important topics such as: study skills, time management, goal setting, test taking, note taking and reading techniques, communication, diversity, and writing skills.

Individual sessions will be based on the text *Becoming a Master Student*. This text is used on many campuses to assist new students during their first year at college, and will be of assistance to students throughout their college careers.

All students living in the residence halls are eligible. Space is limited – students are admitted on a first come, first serve basis.

# RESIDENCE HALLS AT UW-SUPERIOR



## CROWNHART

Is a co-ed hall which houses approximately 170 residents who are returning/transfer students. All the rooms are carpeted. It has a fitness area, computer lab, laundry room, big screen TV, and recreation area with foosball and pool tables. The bed frames are all loft-style and can be placed at standard bed-height or lofted to allow use of the space under the lofted bed. The bathrooms have separate toilet and shower rooms which can be privately locked.



## CURRAN-MCNEILL

Is completely co-ed and houses about 200 residents, the vast majority being freshmen/transfer students. The substance-free floor is located on second floor. This floor is reserved for those who sign a contract and commit to a totally substance-free lifestyle which includes no: chewing tobacco, smoking (tobacco or e-cigarette), drugs, or alcohol. Beds that can be bunked are located on first, second and third floors. The fourth floor has “loftable” bed frames. The hall also has a big screen TV area, fitness area, kitchen, and computer lab.

## OSTRANDER

Is co-ed by floor and houses about 165 residents. Ostrander consists of two floors of males and two floors of females. The first floor is designated for all males. Second floor is designated for freshman females only. Third floor is all females. Fourth floor housing freshman males only. All beds can be bunked and all rooms are carpeted. The hall also has a big screen TV area, study area, kitchen, and computer lab.



## ROSS

Is a co-ed hall with approximately 225 residents. First floor is reserved for non-traditional students. Ross is located about 5 blocks south of the main campus. Third and fourth floor beds can be bunked. All rooms are carpeted. A newly remodeled computer lab, recreation area with big screen TV, and fitness area are available in the hall.

The residence halls offer convenience and great value. All rooms are the same size and have a similar furniture layout.

# LIVING OPTIONS

## SMOKE-FREE ENVIRONMENT

There is no smoking in any of the residence halls at UW-Superior. Smoking is only allowed 25 feet from the buildings. To view the University smoking policy, please visit the web site: [uwsuper.edu/reslife/forms/upload/smoking\\_policy.pdf](http://uwsuper.edu/reslife/forms/upload/smoking_policy.pdf).

## SUBSTANCE-FREE FLOOR

Second floor Curran-McNeill is offered to those students committed to a substance free lifestyle. Residents on this floor sign a contract agreeing to **NO** use of **tobacco** (including e-cigarettes and chewing tobacco), **drugs**, or **alcohol**.

## NON-TRADITIONAL FLOORS

Ross Hall has first floor reserved for those students who prefer to live in a single room on a floor with other residents who are at least 21 years of age.

## SINGLE ROOMS

There will be a limited single rooms available for upperclassmen/transfers in and throughout the residence halls.

## SECURE FLOOR ACCESS

The first and third floor of Ostrander Hall will be locked (hours dependant on floor vote). Only members of the floor community will be able to gain entry to the floor with their fob during the times the doors are locked.

## SINGLE GENDER FLOORS

The second and third floor of Ostrander Hall house females only and the first and fourth floor of Ostrander house males only. All other floors in the residence halls are co-ed.

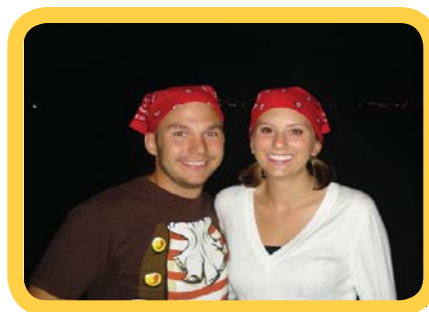

# STUDENT ROOMS: WHAT'S PROVIDED?

## WHAT'S ALLOWED? WHAT'S NOT?

### STUDENT ROOMS

Each room is **furnished** with beds (standard twin-size sheets fit our mattresses), desks with lights above the desk, desk chairs, bookcases, dressers, mirrors, smoke detector, door peephole, cable TV and two Internet connections, window blinds and carpeting. University-owned furniture and fixtures must remain in your room.

Your room will be your “home away from home” so please feel free to personalize it. Keep in mind there is limited electrical capacity and space. We encourage you to contact your roommate to minimize duplications. Power strips with their own breakers are permitted; wall outlet add-on units and extension cords are not.

Please **arrange your room furnishings** so staff members are not hindered from performing necessary repairs or maintenance. There must be at least 24 inches of clear space from floor to ceiling in front of windows, heat vents and thermostats. Access to and exit from a room must be unrestricted.

The door and wall area outside your room are considered extensions of your room. They should not be decorated in a manner that would be considered either a fire hazard or inappropriate or offensive in any way.

All of Crownhart Hall, 4th floor of Curran-McNeill, and the west wing of 2nd floor Ross Hall have bed frames that are completely adjustable to various heights. One can loft a bed, keep it at standard height, or adjust to somewhere in between. Traditional, bunkable beds are provided on all other floors.

Free-standing bunk beds and lofts are allowed in the rooms. Water beds and pressurized bunks and lofts are not allowed in the residence halls.

### LOFT RENTAL

Collegiate Marketing provides loft rental to residence hall students. Lofts ordered before August 1st will be set up in the room before the academic year begins. Students who order after August 1st will be responsible for assembling the loft on their own. For more information, visit Collegiate Marketing's web site at [www.bedloft.com](http://www.bedloft.com).

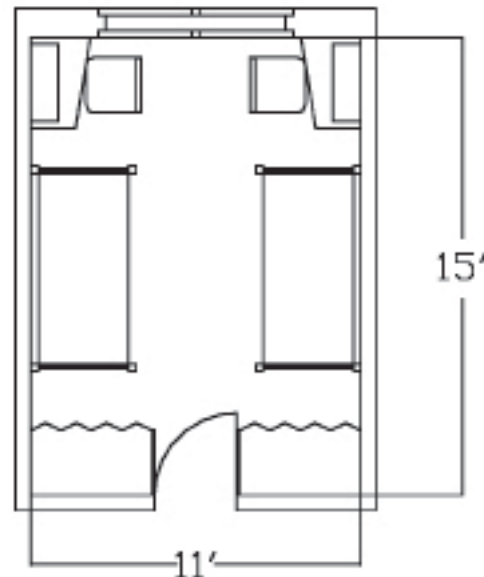

**TYPICAL RESIDENCE HALL  
ROOM LAYOUT  
11' x 15'**

# STUDENT ROOMS

## TELEPHONES

You are responsible for providing your own telephone. One telephone number is assigned per room.

## CABLE TV

All residence hall rooms have cable television hook-up to provide access to about 70 cable TV stations.

## RESNET

The University Residence Life Network (ResNet) provides voice, video and data services to the residence hall rooms. Your room is wired for high-speed Internet access, cable TV service, and telephone service.

When you bring a computer to campus, you will be required to use our on-line registration system to gain network access. This registration system will check your computer for certain vulnerabilities. You will also be required to install the school supplied antivirus program to your Windows-based PC computer (excludes MAC and LINUX computers), which will be made available during registration.

For more information, please visit [uwsuper.edu/resnet/](http://uwsuper.edu/resnet/) or contact ResNet at 715-394-8439.

## APPLIANCES AND FIRE HAZARDS

We want you to make your room as comfortable as possible. However, food preparation in an extensive and/or ongoing manner is not permitted in residence hall rooms. Approved appliances include: small microwaves (600-700 watts and 1-cubic-foot maximum; no more than one per room), hot air popcorn poppers, electric coffeepots and other appliances without an exposed heating element which are cool to the touch during operation and are UL listed; clothes irons with temperature settings, along with hair curlers and other electric cosmetic devices; televisions and stereos (bring headphones so you can enjoy your music and TV without disturbing others). Check with your roommate to make sure you don't duplicate things.

Items NOT allowed include: hot plates, toasters, fryers, space heaters, appliances with exposed heating elements, gas/propane powered appliances, resident-provided refrigerators larger than 5 cubic feet (**only one refrigerator allowed per room**), stand-alone freezers, air conditioners, and extension cords. Also, due to fire hazard, halogen lamps and the burning of candles, potpourri, incense, etc., are not allowed. Food left cooking and unattended is considered a fire hazard. Fire alarms triggered by cooking may result in disciplinary action and fines.



# HALL SERVICES

## WE HAVE WHAT IT TAKES TO MEET YOUR NEEDS

### REFRIGERATORS

Refrigerators are available for rent at each hall front desk for \$20 a semester. Microfridges (refrigerator-freezer-microwave combination) are available for \$40 a semester. Pick-up and drop-off times will be posted at your front desk. Students are responsible for transporting and cleaning of the refrigerator. No refunds are given on refrigerator rentals. Students may provide their own refrigerator (no more than 5 cubic feet). Only one refrigerator is allowed per room.

### RECYCLING

Students living in the halls are required by state law to recycle paper (newspapers, magazines, cardboard, and paperboard), aluminum, tin, glass, and plastic. Residents are responsible for proper disposal of their garbage and recycling materials.

### COMPUTER LAB

A computer lab is located in each hall with several computers and a printer available for your use. ResNet maintains the labs.

### FRONT DESK

Each hall has a front desk that is open daily except during break periods. The front desks of each hall are open from 3 pm-12 midnight each day. The front desk is where you can purchase snacks and other convenience items, rent a refrigerator, and check out a Nintendo Wii, vacuum cleaner, kitchen supplies, and games.

### FLOOR LOUNGES AND TUTORS

Lounges are available for gathering with friends to socialize or study. Tutoring services are available in each hall for writing, math, and basic science classes. Details will be posted each semester.

Livin' the HIVE life...



# HALL SERVICES

## FITNESS/GAME AREAS

Each hall has a fitness area with treadmills, other exercise equipment, and exercise mats. Pool tables are located in each hall along with ping pong and foosball tables. CMO has a sauna.

## VENDING MACHINES

Candy, soda, and snacks are available in each hall.

## CLEANING

You are responsible for cleaning your room and properly disposing of your garbage and recycling materials. The custodial staff works hard to make your hall a comfortable and pleasant place to live. Your cooperation in caring for the facilities will make their jobs easier and will create a more pleasant atmosphere.

## KITCHENS

Feel like making cookies or cooking a meal? Each hall has a kitchen located in the basement for your use. Ross Hall's kitchens are located on the 2nd floor and in the basement. All have a refrigerator, stove, oven and microwave oven. Cooking utensils are available at the front desk. Cleanliness of kitchens is the responsibility of the person(s) using them. Kitchen privileges will be suspended if the kitchens are not kept clean.

## LAUNDRY

Coin-operated washers and dryers are available in each hall basement at \$1.25 per wash and dry cycle.

## MAINTENANCE

Our maintenance staff keeps things in working order. If something needs fixing in your room or residence hall, please fill out a work order online at our website [uwsuper.edu/reslife](http://uwsuper.edu/reslife) or contact your Resident Assistant. A request for maintenance indicates your permission for a maintenance worker to enter your room.

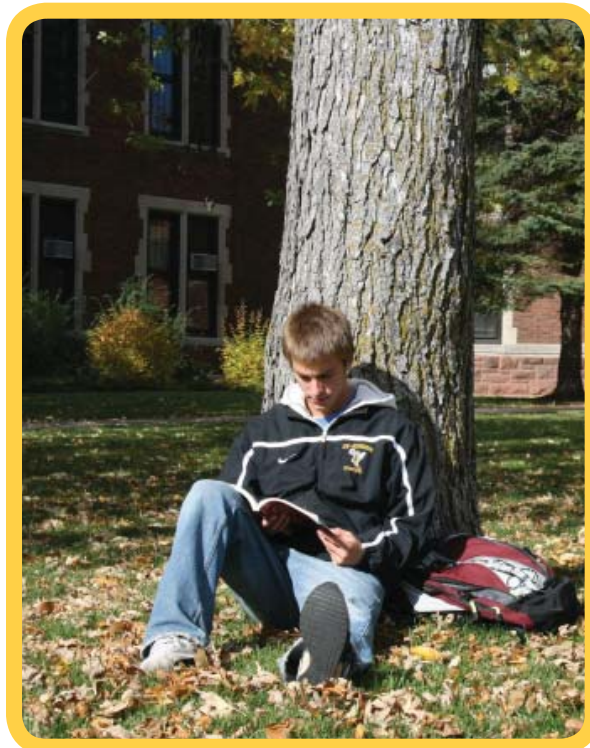

# LIFE IN THE RESIDENCE HALLS

## INFORMATION YOU NEED TO KNOW ABOUT CAMPUS LIVING

### SAFETY IN THE HALLS

Building and bathroom doors are locked 24 hours a day. Residents use their building fob to gain access to both their hall and bathrooms. (A fob is a small security hardware device or electronic key that allows access into locked areas/buildings. Residents are responsible for securing the door and making sure non-residents do not enter the building. Telephones are located in each entryway in case of an emergency or to contact residents after the building has been locked.

### CAMPUS SAFETY

The University's Campus Safety Office is available 24 hours a day. Officers are available for escort service and to assist in emergencies. They can be contacted at 715-394-8114.

### PARKING CARS ON CAMPUS

Residents who bring a car to campus need to purchase a parking permit from Parking Services. Residents will be required to move their cars for snow removal. Notices will be posted at entry doors. Parking Services can be contacted at 715-394-8117.

### BIKES

Residents who bring bikes to campus should lock them when not in use. Bike racks are available in front of each hall. All bikes should be registered with Campus Safety.



### MAIL

Each resident is assigned an individual mailbox. You will be notified of your three-digit mail number and mailing address before you arrive on campus. Mailboxes are located in the Yellowjacket Union next to the Union Information Desk. Mail is delivered Monday through Friday (except for holidays) and is placed in mailboxes by 4 p.m. To receive mail, please have people address your mail properly. Otherwise, it may be delayed or returned to sender.

When you receive a package too large to fit in your box, a package slip will be placed in your box instead. Bring the package slip to the Union Information Desk to sign for and receive your package.

### FORWARDING MAIL:

When you move out of the halls, you need to notify the Registrar's Office of your new address as well as complete a forwarding address card as part of your hall check-out. Your mail will be forwarded for six months after your departure. After that time, it will be returned to sender.

### YOUR MAIL SHOULD BE ADDRESSED AS SHOWN:

Full First and Last Names  
(please no nicknames)  
1600 Catlin Avenue #4xxx  
Superior, WI 54880

# LIFE IN THE RESIDENCE HALLS

## GUESTS

Roommates have the option of establishing their own guest and visitation policy for their room by completing the Roommate Agreement form. Please get your roommate's permission in advance before having an overnight guest. Your roommate's preference to not have guests in your room takes precedence over your right to have a guest. You are responsible for your guests' behavior and to make sure they follow hall policies.

## PETS

Due to possible allergies and sanitation problems, the only pets allowed in the residence halls are aquarium FISH in a 20-gallon tank or smaller.

## QUIET AND COURTESY HOURS

Maintaining a positive living and academic community is important to us. Therefore, quiet hours are in effect in each hall from 10 p.m. to 10 a.m. Sunday through Thursday and midnight to noon Friday and Saturday. **Respecting fellow hall members' need for quiet (courtesy hours) is in effect 24 hours a day.** Quiet hours also apply outside the halls in areas such as courtyards and parking lots.

Additional quiet hours will be in effect the last two weeks of each UW-Superior semester. Noise violations during these two weeks will automatically result in a fine with no warning given. Quiet hours are also in effect during breaks and holidays.

## ALCOHOL

Residents who are of legal drinking age may consume alcohol only in their room or in a room where both residents are 21 years or older or on the substance free floor.

## SMOKING/TOBACCO USE

Smoking is not allowed in the halls. Smokers need to be at least 25 feet from any building to smoke. The use of chewing tobacco and the smokeless e-cigarettes are restricted to a resident's own room (except on the substance free floor). The full UW-Superior smoking policy can be found at [uwsuper.edu/reslife/forms](http://uwsuper.edu/reslife/forms).



# HALL INVOLVEMENT



## RESIDENCE HALL ASSOCIATION

Residence Hall Association (RHA) is a student group which represents the needs and opinions of residence hall students and serves as an important link between the central housing office and residents. RHA also works to improve the quality of the residence hall experience by planning programs that promote community development and social interaction. Visit the RHA web site [atuwsuper.edu/rha](http://atuwsuper.edu/rha).



## RESIDENCE HALL OLYMPICS

Residence Hall Olympics is a system that rewards residents for attending floor programs and becoming actively involved in their hall community. When residents attend programs their floor earns “Olympics points” for its residents engaging in their community. Three times each semester one floor from each hall is recognized as the Hall Olympics winner for their respective building.



## JACKET RACKET

Jacket Racket is a Residence Life group looking to get students more involved within the University and the residence halls. The goal of Jacket Racket is to enhance and promote school spirit within the residence halls, and help residents explore what it means to be a Yellowjacket. Students will become involved and let their black and gold shine through school spirit competitions, Black and Gold Fridays, and other Yellowjacket focused programs. Look for promotions in your residence hall for details.



## ACADEMIC BETTERMENT COMMITTEE

Academic Betterment Committee (ABC) is a Residence Life group focused on making the most of residents’ academic experience here at UWS. Comprised of all five of the academic resource coordinators on campus, ABC’s mission is to provide residents, ranging anywhere from new freshman to seniors and non-traditional students, with academic support in the areas specific to their academic standing. Promotions will be posted for each individual hall highlighting monthly events.



## HIVE NIGHT

Hive night happens in each residence hall several times a semester. Various members of the UW-Superior faculty and staff come through the residence halls and visit with our residents. They obtain useful feedback regarding programs at UWS and give the residents a chance to meet our staff and faculty.

# DINING SERVICES... MEAL PLAN OPTIONS

## SUPERIOR PLAN

*Superior Plan* participants will have access to the Union Cafe during all scheduled hours. The Union Cafe will provide service from 7:30 am-10:00 pm Monday- Friday and from 11:30 am-7:00 pm on the weekends. Superior Plan participants must use their Jacket Cash or US dollars for retail purchases. As an added bonus, Superior Plan participants will receive five guest passes in the third week of each semester and meals for family members that will be complimentary during orientation in the fall.

## BLACK AND GOLD PLAN

The *Black and Gold Plan* may be used in the Union Cafe or for daily combos offered in retail services anytime the dining locations are open. Students may use as many meals per meal period (Breakfast, Lunch, or Dinner) as they want to and may provide meals for guests.

The *Black & Gold Plan* may be customized at the Union Desk anytime after the first day of classes by:

- Using Jacket Cash or US dollars to buy additional blocks of 10 meals
- Converting meals to Jacket Cash in blocks of 10 meals
- Adding Jacket Cash with deposits of \$25.00 or more

## THINGS YOU NEED TO KNOW

**Jacket Cash** is equivalent to U.S. dollars and **may be used** to buy additional meals or food and beverages in the retail services anytime dining venues are open. Jacket Cash is a declining cash balance account that utilizes the UWS Student ID card for purchasing.

**Unused meals and meal plan Jacket Cash do not carry over to the next semester and are NOT refundable.** Meals and meal plan Jacket Cash may be used in the dining services only.

- **Your UW-Superior ID** is needed to access your meal plan. ID cards are available at the Union Desk. ID cards are not transferable and use by anyone but the owner will result in forfeiture and disciplinary action.
- The University dining service will be **more than happy** to work with students who have special dietary needs. Call (715)394-8102 to make an appointment with our **registered dietician**.
- **Students have until the second Friday** of each semester to change their meal plan. Cancellations by non-required participants after that date will be assessed a \$100 cancellation fee.
- **Meals are not served during** any UW-Superior break periods.
- **Due to government health regulations**, removal of food, glassware, utensils and china from serving areas is not permitted.

## QUESTIONS?

If you have any questions, please call or stop by the following offices in Yellowjacket Union:

Dining Services Office (715)394-8102

Union Desk (715)394-8244

# HOUSING AND MEAL CONTRACT

## HOUSING AND MEAL PLAN CONTRACT

The contract is an agreement between you (and your guarantor) and the University. The University agrees to provide you with room and board. You are obligated to pay for such services for the full contract period. We strongly recommend you read the Terms and Conditions of the contract. When you sign the contract, you are signing that you agree to all terms. The contract is for the entire academic year - from September to the end of school in May. (Students who qualify to live off campus may choose the option of a fall-semester-only contract.) Contracts entered into after fall semester begins are legally binding through the remainder of that academic year.

Contract cancellations need to be in writing and received on or before June 1 for partial refund of \$100. Cancellations after July 1 are charged \$200 and after August 1 are \$500.



## HOUSING APPLICATION AND ROOM ASSIGNMENT PROCESS

Fully complete the housing and meal contract and return it to the Residence Life Office along with the \$150 housing pre-payment (freshmen/transfer students ONLY). This payment should not be confused with the admission fee. Please be advised that the \$150 will be deducted from your housing charges placed on your student account.

Each spring continuing residents have a chance to sign up for a room for the following academic year. For this reason, it is not always possible to assign new and transfer students to their listed preferences. We make every attempt to honor those preferences that are available. Spaces are given to new and transfer students based on the date we receive the \$150 pre-payment and contract, mutual roommate requests, and hall preferences. The sooner you return the contract with the \$150 pre-payment, the better chance you have of getting your preferences met.

Roommate preferences must be mutual and your contracts received either together or within one week of each other. Otherwise, assignments are based on the information you provide on the contract whenever possible and are not based on race, ethnicity, religion, sexual orientation or national origin.

### 2011-2012 HOUSING/MEAL PLAN RATES

Housing/Meal	Semester Price
Double Room	\$1570
Single Room	\$2170
(Fall Only contracts please add \$200)	
Superior Meal Plan	\$1340
Black&Gold Meal Plan	\$1140

\*Housing and meal plans *may* change for the 2011-2012 academic year pending Board of Regents approval.

# QUESTIONS, QUESTIONS ...

## ANSWERS TO SOME OFTEN ASKED QUESTIONS

### WHEN WILL I RECEIVE MY ROOM AND ROOMMATE ASSIGNMENT?

Generally, room assignment letters are mailed in late June or early July for fall occupancy and late December or early January for spring occupancy. The room assignment letter includes your room assignment and mailing address, your roommate's name, address, home/cell phone number and e-mail address, if available. It also gives you check-in dates and times.

### ARE SINGLE ROOMS AVAILABLE?

Since the demand for single rooms is high, we cannot typically give a single room to new students. There are more single rooms available in Ross Hall than any other hall and we try to honor those requests until space becomes limited. If you request a single room and one is not available, your name will be placed on a single-room waiting list.

### WHEN CAN I MOVE INTO THE HALLS?

The residence halls open in the FALL for students to move in the day Freshman Orientation begins. For SPRING semester, new and transfer students can move in the day before student orientation begins. To check in, go directly to the front desk of the hall to which you have been assigned. Dates and times of check in are included in your room assignment letter.

### WHAT ABOUT CHANGING ROOMS?

Room changes are difficult to make once an assignment has been made due to lack of available space. See your Hall Manager about possible room changes. All room changes must be made with the permission of your Hall Manager and only as space allows. A \$25 charge is made for room changes. (Exceptions are moves due to consolidation directed from the Residence Life Office.) Residents who are paying for a double room but who have no roommate will be consolidated. (Refer to Room Consolidation in the Terms and Conditions.)



## ... AND MORE QUESTIONS

### WHAT SHOULD I BRING TO CAMPUS?

Bring items to personalize your room such as personal health and toiletry items including a shower caddy and flip flops for the communal showers, a container with handles for carrying dishes to and from the kitchen, laundry bag/basket, quarters for doing laundry, laundry soap, towels, washcloths, linen for a twin-size bed (standard length), bedspread or quilt, pillow, alarm clock, paper, pens, stamps, paper towel and tissues, cell phone, study lamp (150 watts or less; no halogen lamps are permitted), headphones, fan for warmer times, humidifier and winter-appropriate apparel for the winter months.

### CAN I LIVE ON CAMPUS FOR ONLY ONE SEMESTER?

A fall-semester-only contract is available only to students who qualify to live off campus before the first day of fall semester classes by meeting one of the following criteria: (1) have earned 56 credits, (2) are 20 years or older, (3) have previously lived on campus for four semesters. In addition to the semester rate an **additional \$200** will be added for fall semester only contracts.

### ARE THERE COMPUTERS LOCATED IN THE HALLS I CAN USE?

A computer lab is located in each hall with several computers that residents may use. These computers are connected to the University network, e-mail, the Internet, and a network printer.

### HOW DO I CONNECT MY ROOM COMPUTER TO THE UNIVERSITY NETWORK, EMAIL, AND INTERNET?

Please refer to our ResNet web page () for the proper ethernet card and data cable to have installed on your computer and directions on how to link your computer to the Internet.

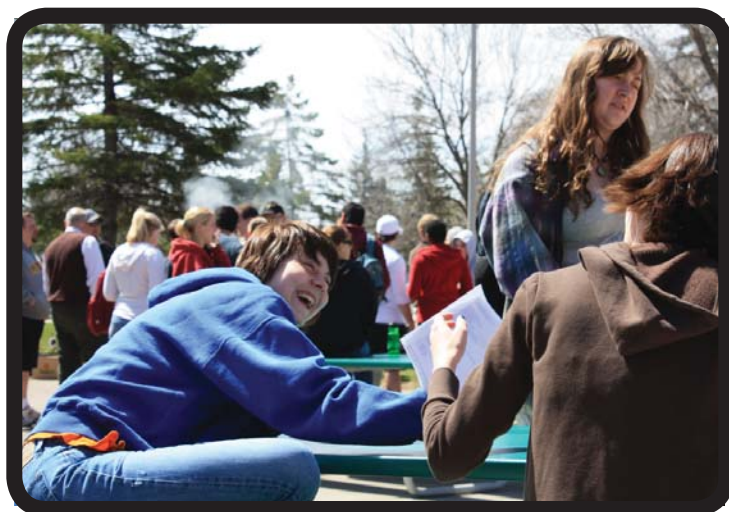

# HOUSING POLICY

## WHO IS REQUIRED TO LIVE ON CAMPUS?

The Board of Regents of the University of Wisconsin passed the following student housing policy:

**“Those freshman and sophomore students (students who have not earned 56 credits or more as of the first day of Fall semester classes) who are not veterans, married or living with parent(s) or guardian shall be required to live in a University-operated residence hall when such accommodations are available.”**

This policy is based on the educational mission of the University and concern for providing support in easing the transition from high school to the University.

## WHO IS ELIGIBLE FOR FALL SEMESTER ONLY CONTRACT AND/OR EXEMPT:

1. Junior/Senior Status-completed 56 credits or more
2. Veterans of Military Service
3. Married and/or with Legally Dependent Children
4. Resided within a University-owned residence hall for at least four semesters
5. Completion of at least two complete years of full-time course study
6. Twenty years of age or more before the first day of classes fall semester
7. Limited Credit Student - six or fewer credits
8. Commuter Student - any student commuting from the home of his/her parent or legal guardian within 35 miles from the University can commute
9. Financial Reasons/Exigency - exemption must be verified by the University Financial Aid Office
10. Medical Circumstances - written verification must be provided in accordance with the following minimum standards when medical circumstances conclusively require that the student not reside in a residence hall.

**Those students who wish to be considered for an exemption to this policy may file an appeal that will be reviewed by the Housing Appeals Committee. Students should contact the Residence Life Office for further information and forms.**

For the full UW Board of Regent requirement policy, visit [uwsuper.edu/reslife/forms/otherforms.cfm](http://uwsuper.edu/reslife/forms/otherforms.cfm).

NOTE: If a student does not qualify for an exemption to the policy at the beginning of the academic year, the student must fulfill the housing and dining contract even though he or she may meet the criteria during the year. Freshmen should not sign a lease with a private landlord for their sophomore year. This creates double obligation that may result in the loss of the security deposit paid for off-campus accommodations.

# DATES TO REMEMBER

## FALL SEMESTER 2011

Hall opening date will coincide with the Student Orientation schedule. Attendance at Student Orientation is required. Please visit [uwsuper.edu/fye/orientation/](http://uwsuper.edu/fye/orientation/) for more information.

September 1	Thursday	Meal plan begins with lunch at 10:30 am
September 6	Tuesday	Classes begin
November 23	Wednesday	Last meal- lunch
November 24-26		Thanksgiving Break- No meals
November 27	Sunday	Meals begin with dinner at 2 pm
December 23	Friday	Last meal- lunch/Halls close at 6 pm for semester break

## SPRING SEMESTER 2012

Hall opening date will coincide with the Student Orientation schedule. Attendance at Student Orientation is required. Please visit [uwsuper.edu/fye/orientation/](http://uwsuper.edu/fye/orientation/) for more information.

January 22	Sunday	Meal plan begins with brunch
January 23	Monday	Classes begin
March 16	Friday	Last meal- lunch
March 17-March 24		Spring Break- No meals
March 25	Sunday	Meals begin with dinner at 2 pm
April 6-7		Holiday break- No meals
April 8	Sunday	Meals begin with dinner at 5 pm
May 18	Friday	Last meal- lunch/ Halls close at 6pm for academic year

## OUR GOAL

The goal of the Residence Life Office is to help students make the most of their collegiate living experience. Our policies and procedures mirror those of the state and University system. Residence Life is entirely self-supporting in providing quality service to students.

## FOR MORE HOUSING INFORMATION, PLEASE CONTACT US:

Residence Life Office

UW-Superior

Belknap & Catlin, Box 2000

Superior, WI 54880-4500

Phone: (715) 394-8438

E-mail: [reslife@uwsuper.edu](mailto:reslife@uwsuper.edu)

Web site: [uwsuper.edu/reslife](http://uwsuper.edu/reslife)

Fax: (715) 394-8454



Our office is located in Yellowjacket Union, at the Information & Services Desk



**RESIDENCE LIFE OFFICE  
PO BOX 2000  
BELKNAP & CATLIN  
SUPERIOR, WI 54880  
(715) 394-8438**