

# Presentation Classroom Instructions For Holden Fine Arts Center 1124



- **Using the AMX Remote System**
- **Adjusting the Volume**
- **Displaying a Video through Projector**
- **Displaying a DVD through Projector**
- **Displaying Computer through Projector**
- **Displaying Laptop through Projector**
- **Displaying the Document Camera through Projector**
- **Displaying Cable Television through Projector**

## Holden Fine Arts Center 1124 Using the AMX Remote System

1. Press anywhere on the AMX touch screen to begin your session (the screen should lower and the projector should turn on).



2. If the Screen did not lower and the projector did not turn on, press the "Projector/Screen" button.



3. Then press “power on” (to turn on the projector) or “down” to lower the screen.

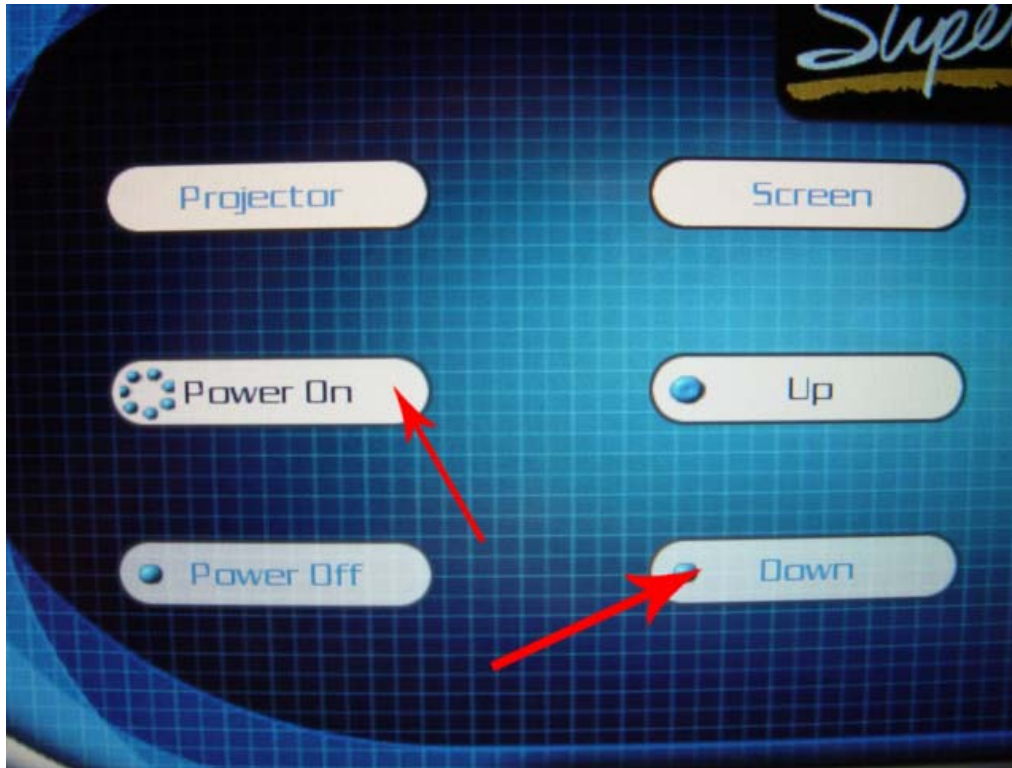

4. To adjust the volume press the “volume” button for volume control.



# Holden Fine Arts Center 1124 Using the AMX Remote System

## Displaying a Video through Projector



1. Turn on the DVD/VCR, press the Select Video to control the VCR player

2. Press the “VCR” button on the AMX screen



3. You can control the VCR from the menu on screen.

# Holden Fine Arts Center 1124 Using the AMX Remote System

## Displaying a DVD through Projector



1. Turn on the DVD Player, press the Select DVD to control the DVD player.



2. Press the Open/Close button to open the disc tray and place the DVD disc on the disc tray. Press the Open/Close button again to close disc tray.

3. Press the DVD 1 button on the AMX Screen.



4. You can control the DVD player from the menu on screen.

Holden Fine Arts Center 1124  
Using the AMX Remote System

Displaying Computer through Projector

1. Press the computer button.



2. Wait for AMX to connect to the computer. The computer is not controlled from the AMX system, but should project to the screen.

# Holden Fine Arts Center 1124 Using the AMX Remote System

## Displaying a Laptop through Projector



1. Connect the Laptop to the cables on the equipment desk.
2. Turn on the Laptop.

3. Press the computer button.

4. Then press the laptop image to select the laptop option.



5. Wait for AMX to connect to the laptop. The laptop is not controlled from the AMX system, but should project to the screen.

# Holden Fine Arts Center 1124 Using the AMX Remote System

## The Document Camera Screen on the AMX

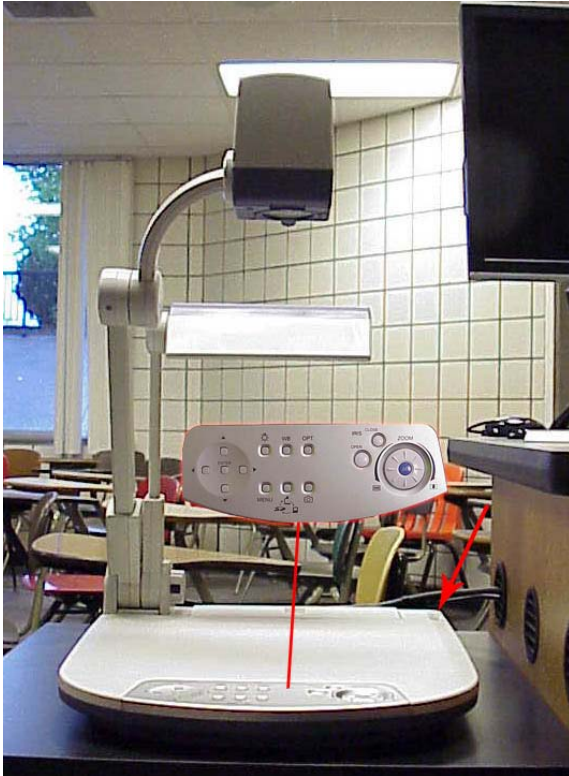

1. Turn on the Document Camera.
2. Place the materials to display on the Document Camera and use the zoom in and out controls as needed.
3. Press the doc cam image on the AMX system to select the doc cam option.
4. Wait for AMX to connect to the document camera. The doc cam is not controlled from the AMX system, but should project to the screen.



Holden Fine Arts Center 1124  
Using the AMX Remote System

Displaying Cable Television through Projector

1. Press VCR on the Source Menu screen.
2. Use the Channel Up and Channel Down buttons to change the channels.
3. Press Exit Source Menu to return to the Source Menu Screen when you are finished using the Cable Television.



## Holden Fine Arts Center 1124 Shut Down

1. Log off the computer like you normal.
2. Turn off the VCR.
3. Turn off the DVD player.
4. Turn off the power and lights on the Document Camera.
5. Press the system shut down button on the AMX menu.



6. Touch yes if you want to shut down AMX.